

PLAYING CARDS

Methods of production

Single Cut (Standard) Data (single pages) Production

- An **inner edge** of around **4 mm** is necessary for each card. (For less than a 4 mm margin, later complaints about the centered position of the graphics are not possible).
- To produce the cards with a standard single-cut, the **colour** of the (inner) **edge** must be set **identically** for all front-sides and set identically for all back-sides. If the (inner) edge is set with a colour, then it's necessary to set a **3 mm** (filled) **bleed** area around.

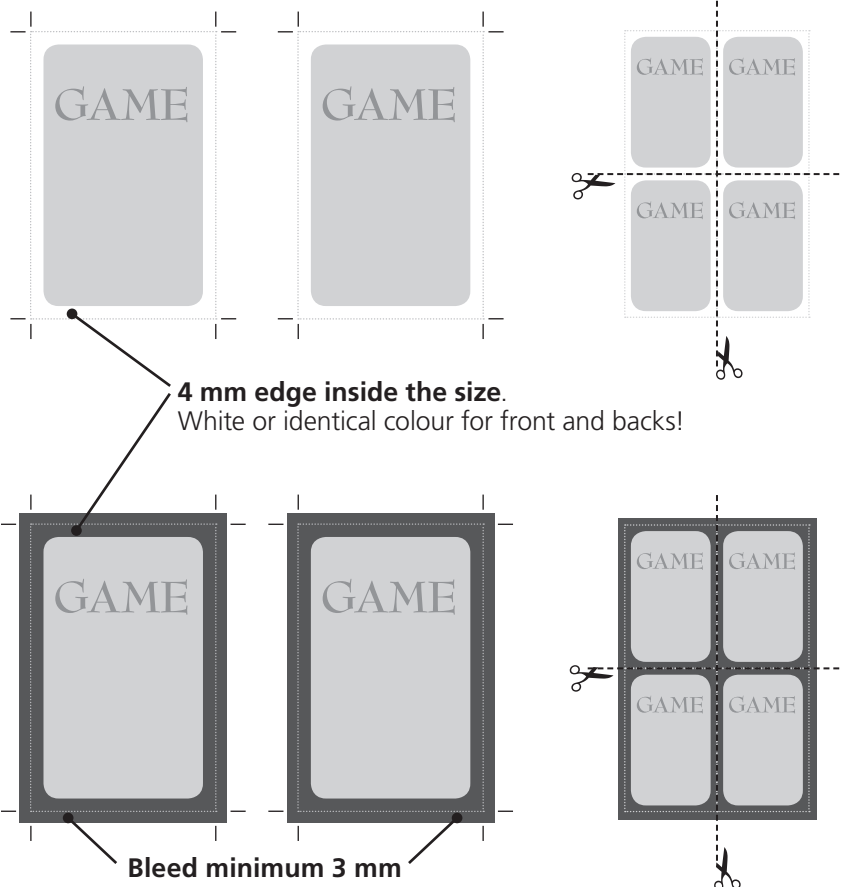

Double Cut (Increased cost!) Data (single pages) Production

- If the inner edges have **different colours** or **bleed-off designed graphics**, the cards have to be produced with an **expensive double-cut**, because neighbouring cards have different color values. In this case, please contact us in advance!
- Around 3 mm of bleed outside the size is necessary.

